

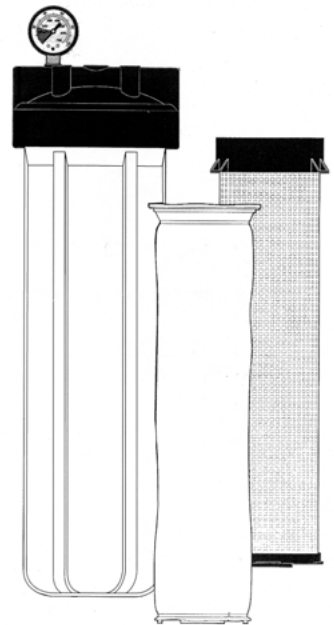

**Puretec®**  
PERFECTING WATER

**⚠ CAUTION**

**DO NOT OVERTIGHTEN.  
DO NOT USE  
LIQUID SEALANTS.**



# User Guide

## MPB202B

MaxiPlus™ Bag Filter Housing

## Puretec Customer Service

Thank you for purchasing a Puretec Bag Filter System. Your system is a patented, proven performer manufactured from only quality materials and components and will give years of clean, fresh, invigorating shower water free of impurities if maintained properly.

**Caution:** Do not use with water that is microbiologically unsafe or with water of unknown quality without adequate disinfection before or after the system.

The system is designed for metropolitan supply water but can be used in other situations. For other types of water supply please contact your local Puretec stockist.

The Puretec Bag Filter System cartridge needs replacing regularly to maintain optimum performance. This is a simple procedure when following instructions. For cartridge replacements contact your stockist.

## Precautions

**Warning:** For drinking water applications, do not use with water that is microbiologically unsafe or of unknown quality without adequate disinfection before or after the system.

**Caution:** Filter must be protected against freezing (when used with aqueous solutions), which can cause cracking of the filter and water leakage.

**Caution:** Because of the product's limited service life and to prevent costly repairs or possible water damage, we strongly recommend that the bottom of all plastic housings be replaced every ten years. If the bottom of your housing has been in use for longer than this period, it should be replaced immediately. Date the bottom of any new or replacement housing to indicate the next recommended replacement date.

## Notes

- Make certain that installation complies with all state and local laws and regulations.
- Do not use wicking or sealer for fitting connections into the cap of the filter. Thread seal tape is recommended for this purpose.
- Do not install where system will be exposed to direct sunlight.
- Allow a minimum of 80 mm clearance under the filter or optional sump stand to facilitate filter changes.

**Installation Note:** A water filter system/tap, like any product, has a limited life and may eventually fail. Also sometimes failure happens early due to unforeseen circumstances. To avoid possible property damage, this product should be regularly examined for leakage and/or deterioration and replaced when necessary. A drain pan, plumbed to an appropriate drain or outfitted with a leak detector, should be used in those applications where any leakage could cause property damage, and/or the water supply should be turned off if no one is home/present.

**INSTALLATION SHOULD BE COMPLETED BY QUALIFIED TRADESPEOPLE.  
FAULTY OPERATION DUE TO UNQUALIFIED PERSONS WILL RESULT IN VOIDED  
WARRANTY COVERAGE.**

## Installation

1. Before installing, verify that the materials of construction of the Puretec Bag Filter System are compatible with the fluid being filtered.
2. The location of the filter should include the following considerations:
  - (1) adequate space for ease of changing the filter bag,
  - (2) drainage or containment to collect drained or spilled liquid, and
  - (3) proper ventilation, if required.
3. When installing the system, include isolation valves for the filter and support for the filter housing. Use caution when applying heat near the filter housing. It is best to weld or sweat all fittings before assembly to the filter. The filter head may be mounted to the filter support using 5/16 inch x 1 ¼ inch long bolts. The bolt spacing is 3 inch on center and the bolt circle is 2-1/8 inch.
4. The filter must be installed in the vertical position with the inlet/outlet ports at the top. Flow through the housing is inline. Note the inlet and outlet ports when connecting piping.
5. The filter housing is equipped with a ¼ inch NPT gauge port on the outlet for installation of a pressure gauge (included) and a 3/8 inch NPT drain port at the base of the sump (3/8 inch NPT ball valve supplied). The gauge or valve should be installed using thread seal tape as a thread sealant.

## Bag Selection

The Puretec Bag Filter Housing is designed for use with Puretec filter bags. Filter bags are available in 1, 5, 10, 25, 50, 100 and 200 micron. Polypropylene is the standard bag material but nylon is available upon request.

## Start-up

1. Open the inlet valve. It is recommended that the inlet valve be opened before the outlet valve to prevent any backflow.
2. Vent trapped air from the system before opening the outlet valve.
3. Open the outlet valve.

## Bag Replacement

The pressure differential across the bag will remain fairly constant until the bag is approximately 80% blinded off. It is recommended that the bag be changed when the pressure differential reaches 15 psi. However, this figure can vary with the type of filter bag. The bag manufacturer's data should be consulted to determine the actual pressure drop for replacement.

**Warning:** Review all precautions specific to the handling of the fluid being filtered before changing the filter bag. A filter bag that has been used with a hazardous liquid may contain residual amounts of this material and should be handled with the same safeguards that would be used in handling any hazardous and/or toxic material i.e. gloves, respirators, protective eyewear, etc. Filter bags should be disposed of in accordance with federate state or local laws and requirements. Failure to follow precautions may result in injury.

1. Close isolation valves to the filter.
2. Drain sump (See **Warning** above).  
**Note:** If bag has not been changed on a timely basis it may not drain. If necessary, the liquid contents of the used bag can be poured into the replacement bag to be filtered.
3. Unscrew sump from cap. Sump will unscrew counterclockwise.  
**Caution:** Support sump at base while unscrewing to prevent dropping and possibly damaging the sump or drain valve.
4. Remove basket assembly from sump (See **Warning** above).
5. Remove bag from basket.
6. Remove O-ring from groove in the sump and wipe groove and O-ring clean. Re-lubricate O-ring with food grade silicone lubricant or similar. Insert O-ring in place and press into groove.  
**Note:** This step is important to ensure a proper housing seal. Make certain the O-ring is seated level in the groove.
7. Insert new bag into the basket. Form the bag to the contours of the basket making sure that the bag extends fully to the bottom of the basket.  
**Note:** Make sure the filter bag overlaps the bag collar to insure a proper seal when the filter housing is closed.
8. Screw the sump onto the cap and hand-tighten securely. Do not over-tighten.

**Figure**

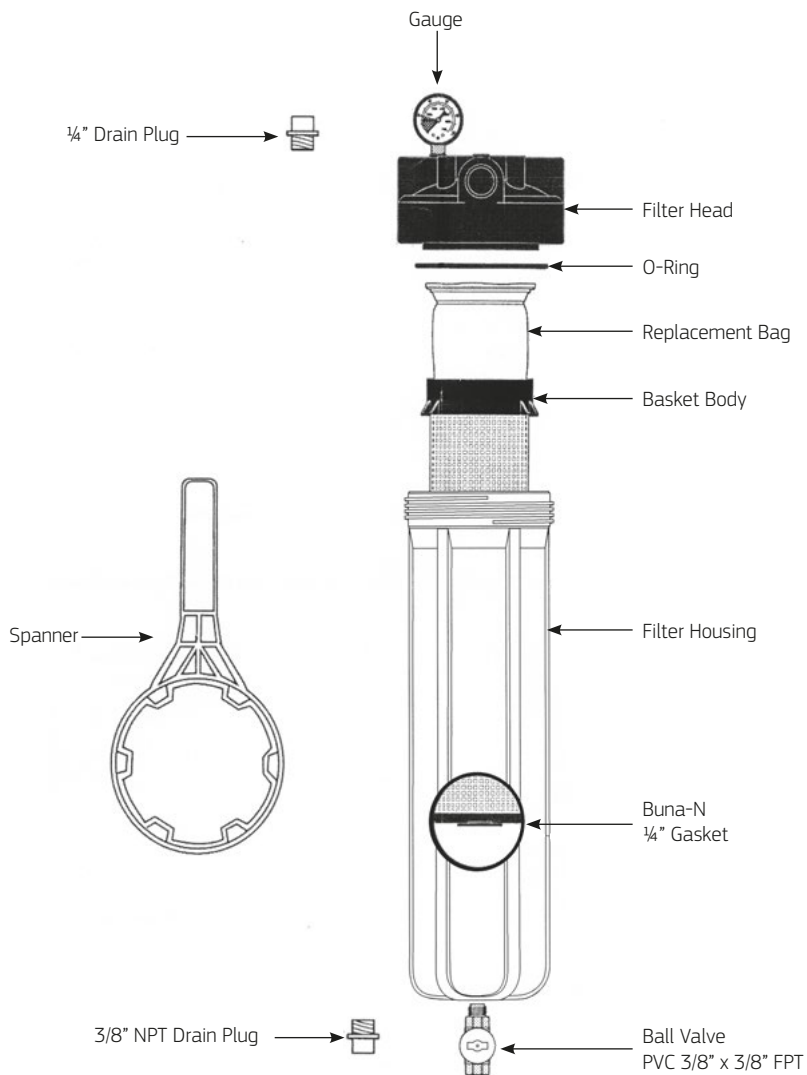

## Specifications

Max. Pressure:	520 kPa
Maximum Temperature:	37.7°C ( 100°F)
Recommended Service Flow Rate:	21 kPad @ 132 Lpm
Maximum Service Flow Rate:	21 kPad @ 180 Lpm

**Note:** Where line pressure exceeds 500 kPa, an approved pressure limiting device must be installed to comply with Australian & New Zealand Plumbing Standards.

## Materials of Construction

Filter Cap:	Polypropylene
Filter body 20-inch:	Polypropylene
Basket 20-inch:	Polypropylene
Gasket:	Buna-N or EPR
O-ring (Sump):	Buna-N
Vent Plug:	Polypropylene
Drain Plug:	Polyethylene
Drain Valve:	PVC
Seals:	Buna-N
Gauge:	Brass & Bronze
Spanner Wrench:	Polypropylene

## Dimensions

Diameter:	180 mm (7¼")
Height:	600 mm (24")

**Note:** Allow extra 300 mm height for cartridge changes.

## Troubleshooting

### Leaks

1. Check the O-ring for dirt, cuts, or swelling. Replace O-ring if necessary.
2. Make sure housing is closed properly. Hand-tighten securely. Do not over-tighten.
3. Check all threaded connections and re-thread as needed.
4. Check to see if the filter bag is dirty and blinded over (see **Warning** under Bag Replacement). If this is the case, replace bag according to instructions.

### Poor Filtration Results

1. Check to make sure the filter bag is properly seated in the support basket (see **Warning** under Bag Replacement). The bag should extend fully to the bottom of the basket and the top should overlap the sealing collar.
2. Check for rips or tears in the filter bag.

## Notes

The complete range of Puretec products are developed, refined and made to meet and exceed stringent specifications for the worldwide market.

**Important Note:** Sales of products are subject to our Terms & Conditions which are available upon request. All specifications, prices and photos are a guide only and are subject to change without notice. Please ring to confirm details. Do not use products with microbiological unsafe water without adequate disinfection. Under normal circumstances a pressure limiting valve is not required. If incoming water pressure is excessive it may however be necessary to install an approved pressure limiting valve. Maximum flow depends on cartridge, vessel, pressure, impurities etc.

## Warranty

**Warranty:** Any claim under this warranty must be made within 3 years of the date of purchase of the product. This product is warrantied to be free of defect of material and workmanship for 3 years from date of purchase.

Puretec is renowned for its quality and after-sales support so if you have any issues please call 1300 140 140 (AU) or 0800 130 140 (NZ). To make a warranty claim, contact us directly or the place of original purchase. All costs relating to a warranty claim must be approved by Puretec prior to any work being carried out.

3 year warranty is 1 year parts and labour, plus 2 years parts only. Puretec will pay your reasonable, direct expenses of claiming under this warranty. You may submit details and proof of your expense claim to place of purchase for consideration.

### Warranty/Australia

This warranty is given by Puretec Pty Ltd, ABN 44 164 806 688, 37-43 Brodie Road, Lonsdale SA 5160, telephone no. 1300 140 140 and email at [sales@puretec.com.au](mailto:sales@puretec.com.au).

This warranty is provided in addition to other rights and remedies you have under law: Our goods come with guarantees which cannot be excluded under the Australian Consumer Law. You are entitled to replacement or refund for a major failure and to compensation for other reasonably foreseeable loss or damage. You are also entitled to have the goods repaired or replaced if the goods fail to be of acceptable quality and the failure does not amount to a major failure.

### Warranty/New Zealand

This warranty is given by Puretec Ltd, Reg. No 4464398, Po Box 875 Cambridge 3450 NZ, telephone no. 0800 130 140 and email at [sales@puretec.co.nz](mailto:sales@puretec.co.nz).

This warranty is provided in addition to other rights and remedies you have under law: Our goods come with guarantees which cannot be excluded under the Australian Consumer Law. You are entitled to replacement or refund for a major failure and to compensation for other reasonably foreseeable loss or damage. You are also entitled to have the goods repaired or replaced if the goods fail to be of acceptable quality and the failure does not amount to a major failure.

The warranty only applies if the product was used and/or installed in accordance with the user guide and/or installation instructions. This warranty is given in lieu of all other express or implied warranties and manufacturer shall in no circumstance be held liable for damages consequential or otherwise or delays caused or faulty manufacturing except as excluded by law.

Applicable to all above, is that the Warranties need to be approved by Puretec to ensure product was not incorrectly used, installed or claimed. False and incorrect claims will be pursued at Puretec's discretion, including chargeable inspection and labour costs incurred.



9 1341362 023049 1

#### AUSTRALIA

P 1300 140 140

E [sales@puretec.com.au](mailto:sales@puretec.com.au)W [puretec.com.au](http://puretec.com.au)

#### NEW ZEALAND

P 0800 130 140

E [sales@puretec.co.nz](mailto:sales@puretec.co.nz)W [puretec.co.nz](http://puretec.co.nz)